

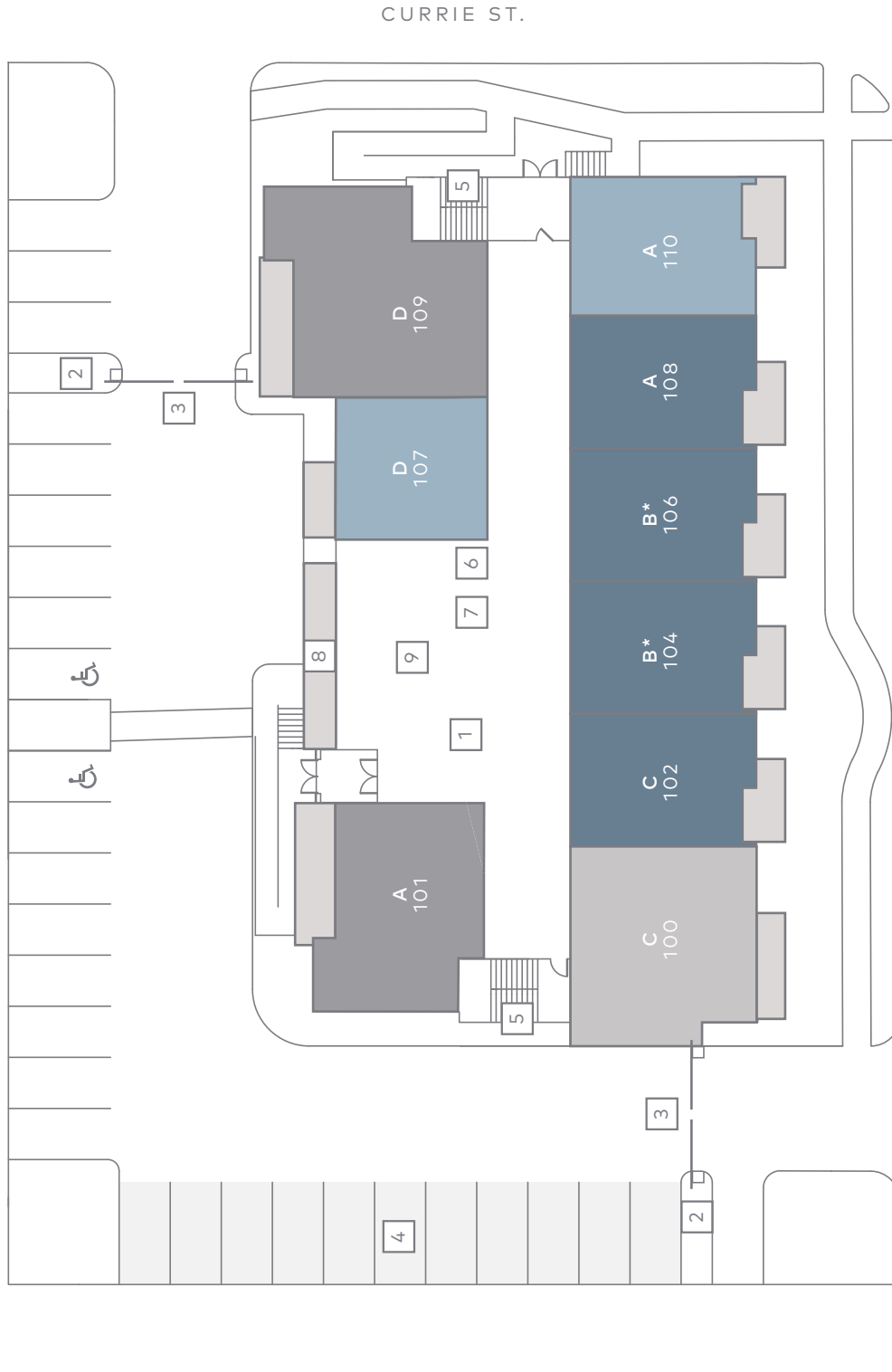

- THE WIMBERLY
 - THE WHITMORE
 - THE WINGATE
 - THE FOCH
- *Wheelchair Accessible
- 1 REFUSE
 - 2 PEDESTRIAN GATE
 - 3 GATE - EXIT ONLY
 - 4 COVERED PARKING
 - 5 BIKE STORAGE
 - 6 OFFICE
 - 7 ELEVATOR
 - 8 LUXER PACKAGE LOCKERS
 - 9 GATE - ENTRY ONLY
 - 10 MAIN ENTRY





WHITMORE ST.

CURRIE ST.

- | | | |
|--------------|---------------------|------------------------|
| THE HAMILTON | 1 ELEVATOR | 6 BATHROOM |
| THE WIMBERLY | 2 PEDESTRIAN GATE | 7 KITCHENETTE |
| THE WHITMORE | 3 GATE - ENTRY/EXIT | 8 OUTDOOR PATIO |
| THE WINGATE | 4 COVERED PARKING | 9 GYM / MULTI-USE AREA |
| THE BRISTOL | 5 BIKE STORAGE | |

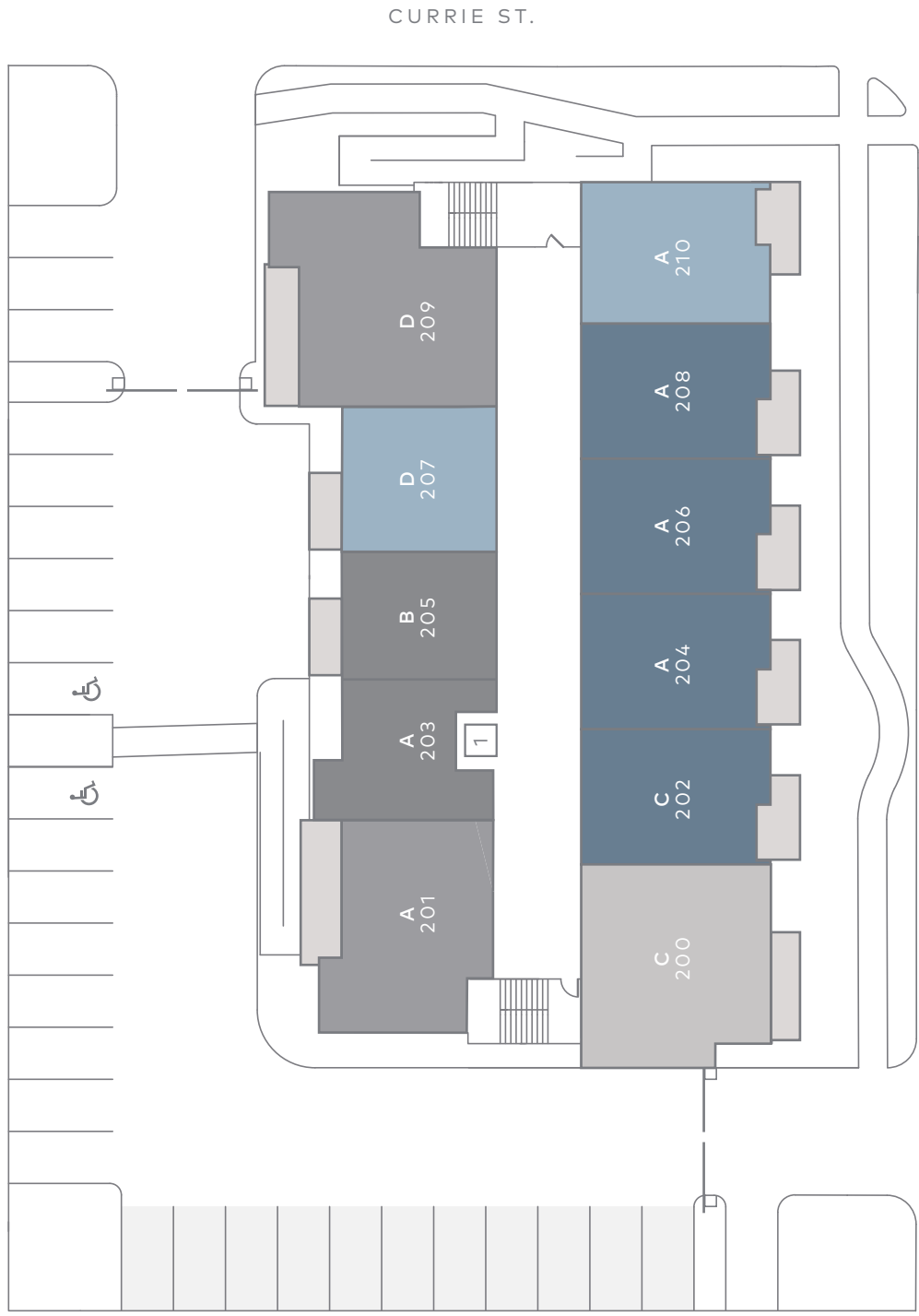

1 ELEVATOR

- THE HAMILTON
- THE WIMBERLY
- THE WHITMORE
- THE WINGATE
- THE BRISTOL



1 ELEVATOR

- THE HAMILTON
- THE WIMBERLY
- THE WHITMORE
- THE WINGATE
- THE BRISTOL